

KFD STO M 14 R

Technical data

Version **04/2020**

HEATING & TECHNICAL PARAMETERS:		
energy efficiency class	A-B-C-D-E-F-G	
direct heat output (nominal power)	[kW]	~9
heating power range	[kW]	6 - 16
energy efficiency index	[EEI]	
energy efficiency at nominal heat output	[%]	>75
seasonal space heating energy efficiency	[%]	>65
CO emission at 13% O ₂	[%]	<0,12
	[mg/Nm ³]	<1500
dust emission at 13% O ₂	[mg/Nm ³]	<40
OGC at 13% O ₂	[mg/Nm ³]	<120
NO _x emission at 13% O ₂	[mg/Nm ³]	<200
flue gas mass flow	[g/s]	
average smoke temperature at smoke outlet	[°C]	
minimum chimney draft	[Pa]	12
DIMENSIONS & WIGHT		
total dimensions, height x width x depth	[mm]	890 x 692 x 470
fascade dimensions, width x height	[mm]	692 x 534
side fascade dimensions, width x height		470 x 534
front glass dimensions, width x height	[mm]	635 x 343
side glass diemnsions, width x height		309 x 343
maximum log lenght	[cm]	50
smoke flue diameter	[mm]	160 / 180
air inlet diameter	[mm]	*100
weight	[kg]	175
CERTIFICATES AND NORMS		
EN 13229	V / -	
declaration of the Ecodesign requirements	V / -	V
BImSchV level 2	V / -	
15a BVG	V / -	
ADDITIONAL INFORMATION		
for continous burning	V / -	V
preffered type of fuel		wood logs with moisture content ≤ 20 %
ashpan	V / -	V
appliance suitable for low energy and passive	V / -	V
door opening		side
possibility of burning with open door	V / -	-
warranty	years	5

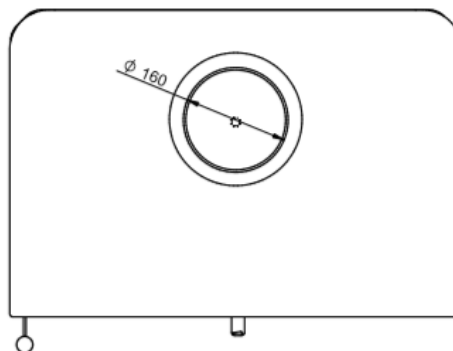
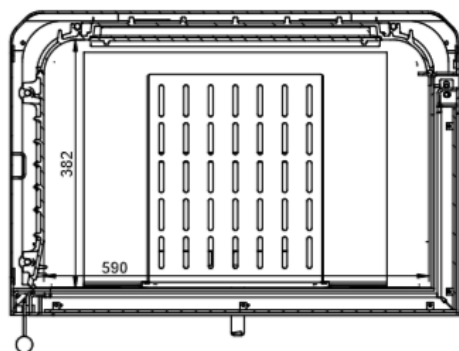
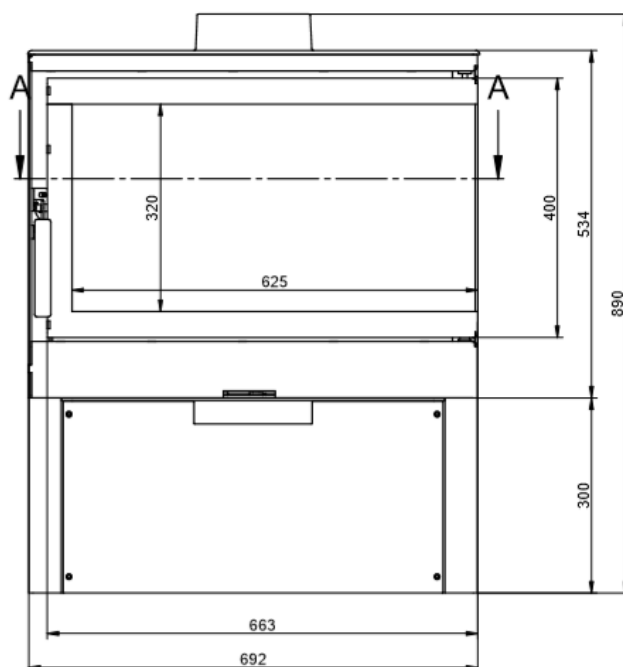
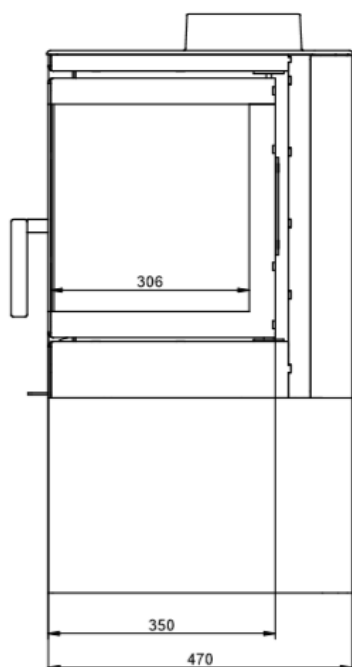

SECTION A-A

All dimensions are approximate
*direct air inlet - optional equipment